

HARDSCAPING PRODUCT DETAILS					
KEY/LOCATION	DESCRIPTION	DIMENSIONS	COLOUR/FINISH	PATTERN	
Paving: Western Services Yard and Forecourt pedestrian areas	Concrete Flag Paving - high slip resistance in accordance with BS EN 1339 - chamfered edges	Plan size: 600x450mm Thickness: 80mm	Medium grey	Half staggered joint format	
Paving: Western Services Yard and Forecourt pedestrian areas	Concrete Flag Paving - high slip resistance in accordance with BS EN 1339 - chamfered edges	Plan size: 450x300mm Thickness: 80mm	Light grey	Half staggered joint format	
Paving: Forecourt pedestrian areas	Concrete Textured Setts - high slip resistance in accordance with BS EN 1339	Plan size: 200x200mm Thickness: 80mm	Anthracite Charcoal	Grid format	
Paving: Forecourt areas where pedestrian and vehicle access is discouraged	Concrete Determent Paving - Formet 3 profile - high slip resistance in accordance with BS EN 1339	Plan size: 600x600mm Thickness: 74mm	White	Grid format	
Metal retainers: Western Services Yard and Forecourt landscape planters	Hi-grade bespoke steel panel system - galvanised steel with chamfered edges	Steel panel thickness: 6mm	Galvanised steel	n/a	

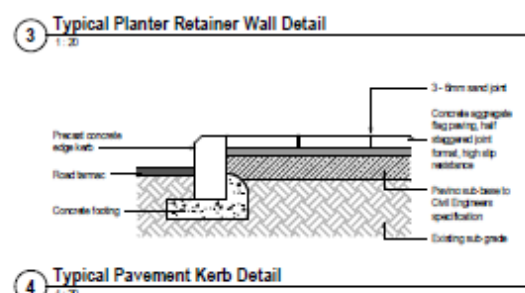
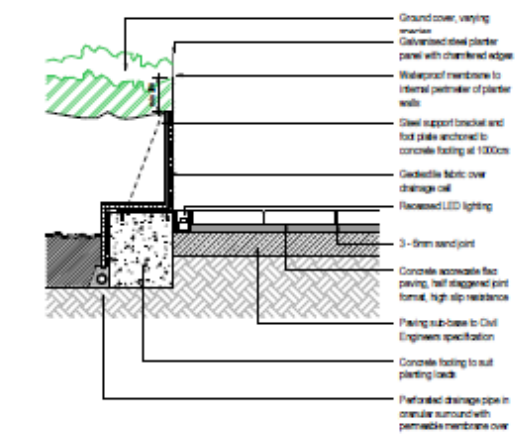

Note:
Any reproduction of Ordinance Survey map work illustrated on this drawing is covered by licence (No. 040151580) issued by the Director (General, Ordnance Survey and allows PASCALL+WATSON Limited ("The Licensee") to copy Ordnance Survey material for their business use. The licensed copy of this drawing is held at the offices of PASCALL+WATSON Limited.

- All information shown outside the Proposed Boundary is for illustrative purposes only.
- Internal layouts are for illustrative purposes only.
- Base building survey information by LCI and MSA.

SCALE BAR

N

B	RC	20.07.18	For Planning Approval
A	RC	06.10.17	For Planning Approval
Rev	On	Date	Description

London City Airport
Get closer.
London City Airport Limited City Aviation House Royal Docks London E16 2JB

PASCALL+WATSON
The Waterhouse 15 Essex Place
Leam Road, SOAF 6ER
T +44 (0)20 3837 2600
www.pascall.co.uk

Client: LONDON CITY AIRPORT
Project Name: CITY AIRPORT DEVELOPMENT PROGRAMME
Condition 36
Terminal Forecourt
Indicative Hardscaping Details

Discipline: Architecture	Project Name: For Approval
Drawing Number: PASCALL+WATSON architects	Signature: 5077
Drawn by: MN	Checked by: RC
Drawn Date: 06.10.17	Checked Date: 06.10.17
Approved by: MN	Approved Date: 06.10.17
Approved Date: 06.10.17	Scale: As indicated

Building Information: CADP

Project	Rev	On	Date	By	For	Project	Rev	On	Date	By	For
A400-PAW-A-14	LO0	XX	DR	DE	735-002	B	63				

Figure 4.0.4: Forecourt indicative hardscaping details for approval.

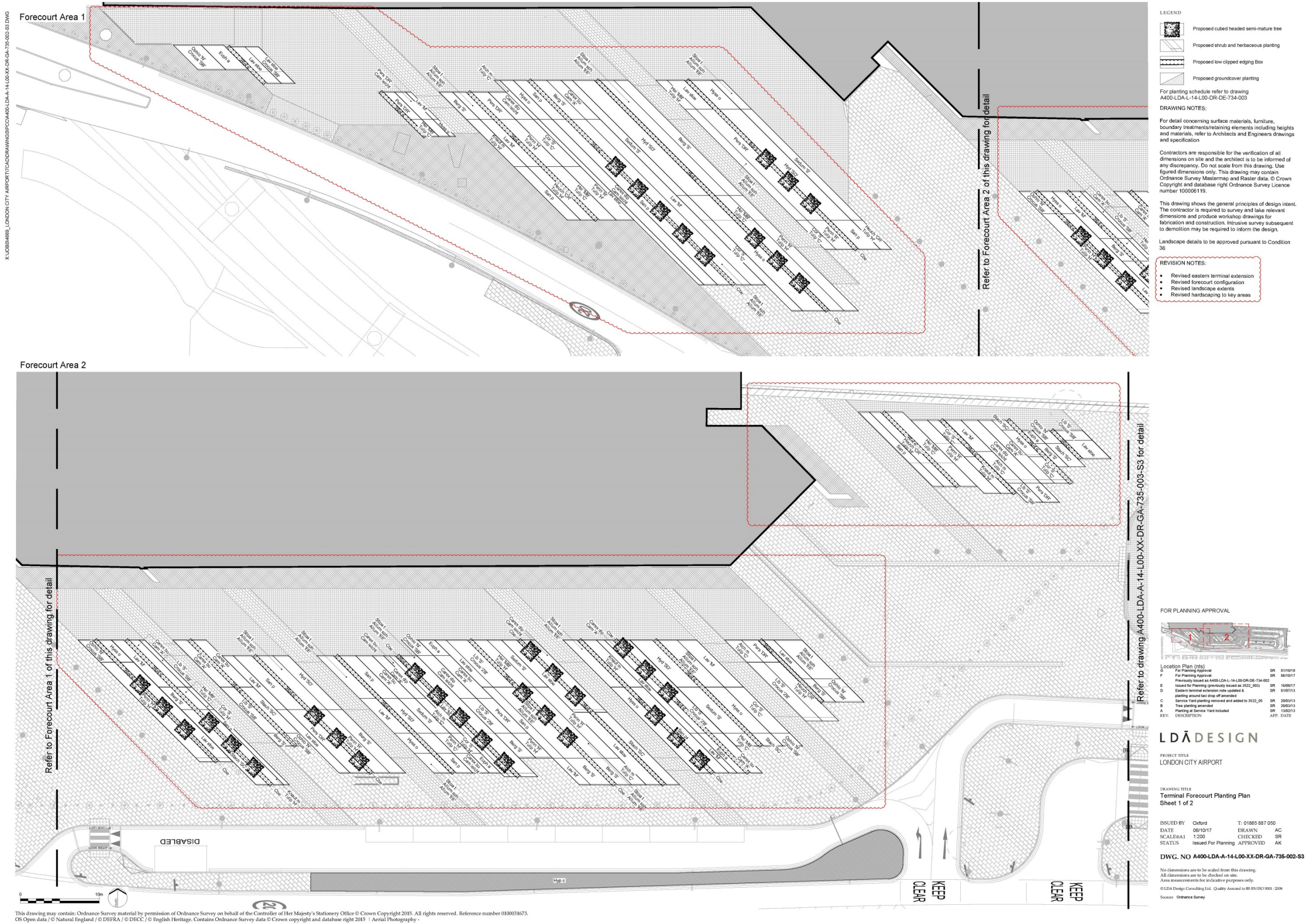

Figure 4.0.5: Forecourt planting plan – Sheet 1 for approval.

X:\03\B469_LONDON CITY AIRPORT\CDR\DRAWINGS\PC\A400-LDA-A-14-L00-XX-DR-GA-735-003-S3.DWG

Trees				
Abbreviation	Species	Girth	Density	Specification
Cbe	Carpinus betulus	20-25cm	Counted	Semi-Mature :Clear Stem min. 2.2m :RB :Cube-Headed

Shrubs					
Abbreviation	Species	Height	Pot Size	Density	Specification
Bux s	Buxus sempervirens 'Suffruticosa'	20-30cm	3L	4/m	Bushy : 8 brks: Maintained at 300mm
Euph a	Euphorbia amygdaloides var robbiae	20-30cm	5L	4/m²	Full Pot
Hyd 'SD'	Hydrangea paniculata 'Silver Dollar'	30-40cm	10L	3/m²	Branched :3 brks
Hyp c	Hypericum calycinum	10-20cm	3L	4/m²	Bushy :5 brks
Hyss o	Hyssopus officinalis	20-30cm	3L	4/m²	Full pot
Lav 'M'	Lavandula angustifolia 'Munstead'	20-30cm	3L	4/m²	Bushy :5 brks
Lav stoe	Lavandula stoechas pedunculata	20-30cm	3L	4/m²	Bushy :5 brks
San p	Santolina pinnata	20-30cm	3L	4/m²	Bushy :7 brks

Grasses				
Abbreviation	Species	Pot Size	Density	Specification
Carex bu	Carex buechananii	3L	5/m²	Full Pot
Carex dip	Carex dipsacea	2L	5/m²	Full Pot
Lib 'S'	Libertia taupo 'Sunset'	2L	6/m²	Full Pot
Ophio 'N'	Ophiopogon planiscapus 'Nigrescens'	2L	10/m²	Full Pot
Penn 'H'	Pennisetum alopecuroides 'Hameln'	3L	5/m²	Full Pot
Penn 'R'	Pennisetum setaceum 'Rubrum'	3L	5/m²	Full Pot
Stipa t	Stipa tenuissima	3L	5/m²	Full Pot

Herbaceous				
Abbreviation	Species	Pot Size	Density	Specification
Alch m	Alchemilla mollis	3L	5/m²	Full Pot
Berg 'S'	Bergenia 'Silberlicht'	3L	5/m²	Full Pot
Cor 'S'	Coreopsis lanceolata 'Sterntaler'	3L	5/m²	Full Pot
Hel 'MB'	Helenium 'Moerheim Beauty'	3L	5/m²	Full Pot
Heuch 'CR'	Heuchera 'Chocolate Ruffles'	3L	5/m²	Full Pot
Knaut m	Knautia macedonia	3L	5/m²	Full Pot
Pers 'DR'	Persicaria affinis 'Darjeeling Red'	3L	5/m²	Full Pot: 20-30cm height
Sedum 'S'	Sedum spectabile 'Stardust'	3L	5/m²	Full Pot
Stach 'SC'	Stachys byzantina 'Silver Carpet'	3L	5/m²	Full Pot

Bulbs			
Abbreviation	Species	Density	Specification
Allium 'EE'	Allium 'Early Emperor'	15/m²	Grade 10/12
Allium sph	Allium schoenoprasum	20/m²	Grade 7/8
Cam leicht	Camassia leichtlinii	20/m²	Grade 10/12
Cam 'A'	Camassia leichtlinii 'Alba'	20/m²	Grade 10/12
Crocus 'SB'	Crocus chrysanthus 'Snow Bunting'	30/m²	Grade 5/7
Crocus 'ZB'	Crocus chrysanthus 'Zwanenburg Bronze'	30/m²	Grade 5/7
Tulip 'C'	Tulipa 'Concerto'	15/m²	Grade 12/+
Tulip 'H'	Tulipa 'Havran'	15/m²	Grade 12/+

LEGEND

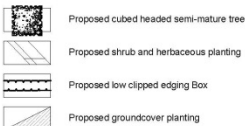

DRAWING NOTES:

For detail concerning surface materials, furniture, boundary treatments/retaining elements including heights and materials, refer to Architects and Engineers drawings and specification

Contractors are responsible for the verification of all dimensions on site and the architect is to be informed of any discrepancy. Do not scale from this drawing. Use figured dimensions only. This drawing may contain Ordnance Survey Mastermap and Raster data. © Crown Copyright and database right Ordnance Survey Licence number 100006119.

This drawing shows the general principles of design intent. The contractor is required to survey and take relevant dimensions and produce workshop drawings for fabrication and construction. Invasive survey subsequent to demolition may be required to inform the design.

Landscape details to be approved pursuant to Condition 36

REVISION NOTES:

- Eastern substation demolished
- Revised eastern terminal extension
- Revised forecourt configuration
- Forecourt bin store omitted
- Revised landscape extents
- Revised canopy extents
- Additional canopy shown

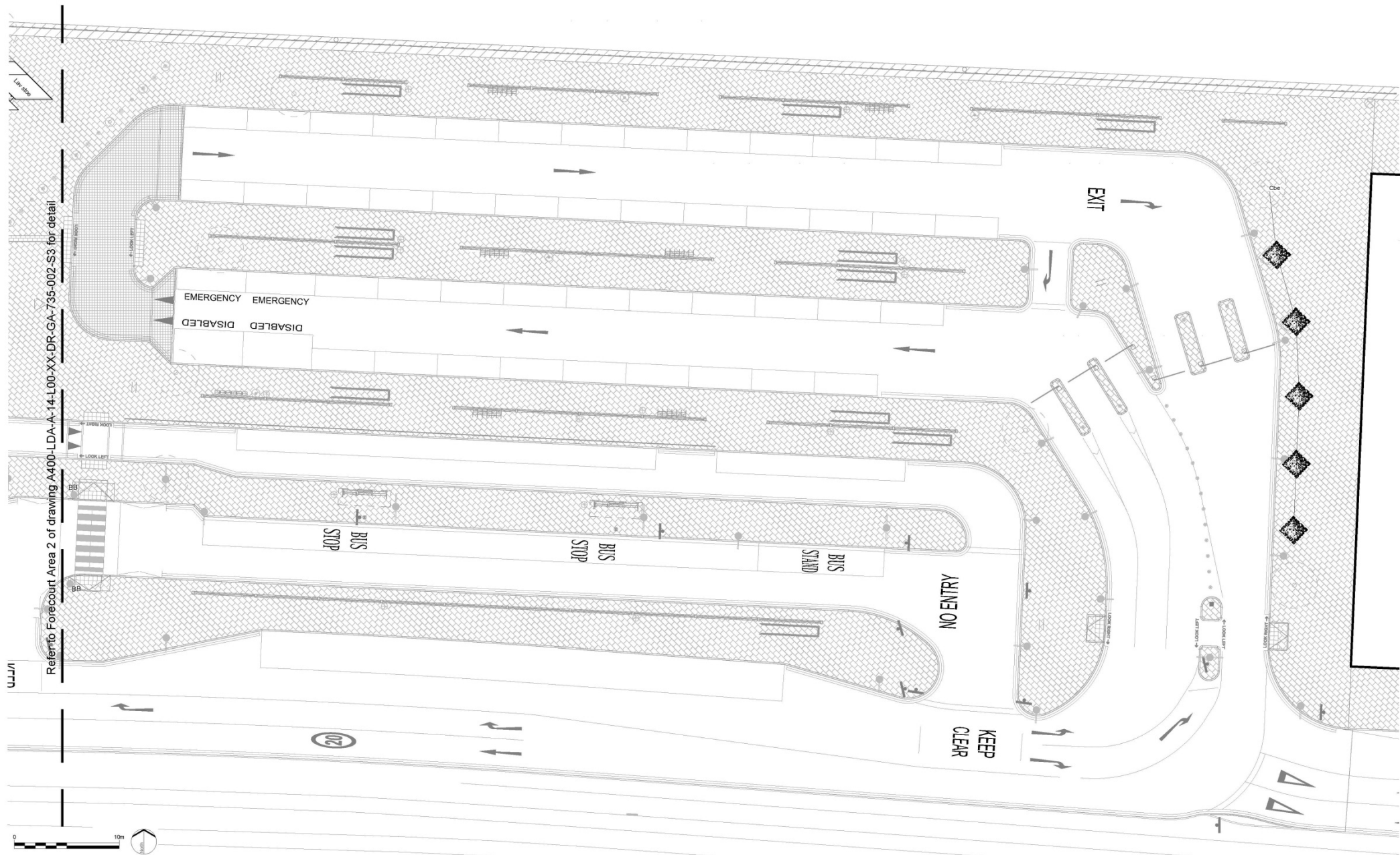

FOR PLANNING APPROVAL



Location Plan (r/s)			
F	For Planning Approval	SR	6110/18
E	For Planning Approval	SR	6010/17
Previously issued as A400-LDA-A-14-L00-DR-DE-734-003			
D	Issued for Planning	SR	1606/17
Previously issued as 3522_004			
C	Issued for Approval	RB	6107/13
B	Time starting amended	SR	2003/13
A	Planting at hotel and substation amended	RB	1303/13
REV.	DESCRIPTION	ATP	DATE

LD&A DESIGN

PROJECT TITLE
LONDON CITY AIRPORT

DRAWING TITLE
Terminal Forecourt Planting Plan
Sheet 2 of 2

ISSUED BY	Oxford	T: 01865 887 050
DATE	06/10/17	DRAWN AC
SCALE/1	1:200	CHECKED SR
STATUS	Issued For Planning	APPROVED AK

DWG. NO A400-LDA-A-14-L00-XX-DR-GA-735-003-S3

No dimensions are to be scaled from this drawing.
All dimensions are to be checked on site.
Area measurements for indicative purposes only.
© LDA Design Consulting Ltd. Quality Assured to BS EN ISO 9001 : 2008
Source: Ordnance Survey

This drawing may contain Ordnance Survey material by permission of Ordnance Survey on behalf of the Controller of Her Majesty's Stationery Office © Crown Copyright 2015. All rights reserved. Reference number 0100031673.
OS Open data / © Natural England / © DEFRA / © DECC / © English Heritage. Contains Ordnance Survey data © Crown copyright and database right 2015 / Aerial Photography

Figure 4.0.6: Forecourt planting plan - Sheet 2 for approval.