

OS map data reproduced by permission of Ordnance Survey on behalf of HMSO. © Crown copyright 2021. All rights reserved. Ordnance Survey licence number 0100040692

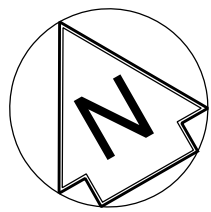

Indicative bridleway (exact details to be agreed by planning condition)

Great North Road

Lower Peckfield Lane

Recreation ground

Indicative bridleway (exact details to be agreed by planning condition)

Railway - Leeds to Hull lines (ELR: HUL4)

Pit Lane

Peckfield Level Crossing to be closed

Proposed: Bridleway Plan View  
Scale 1:500

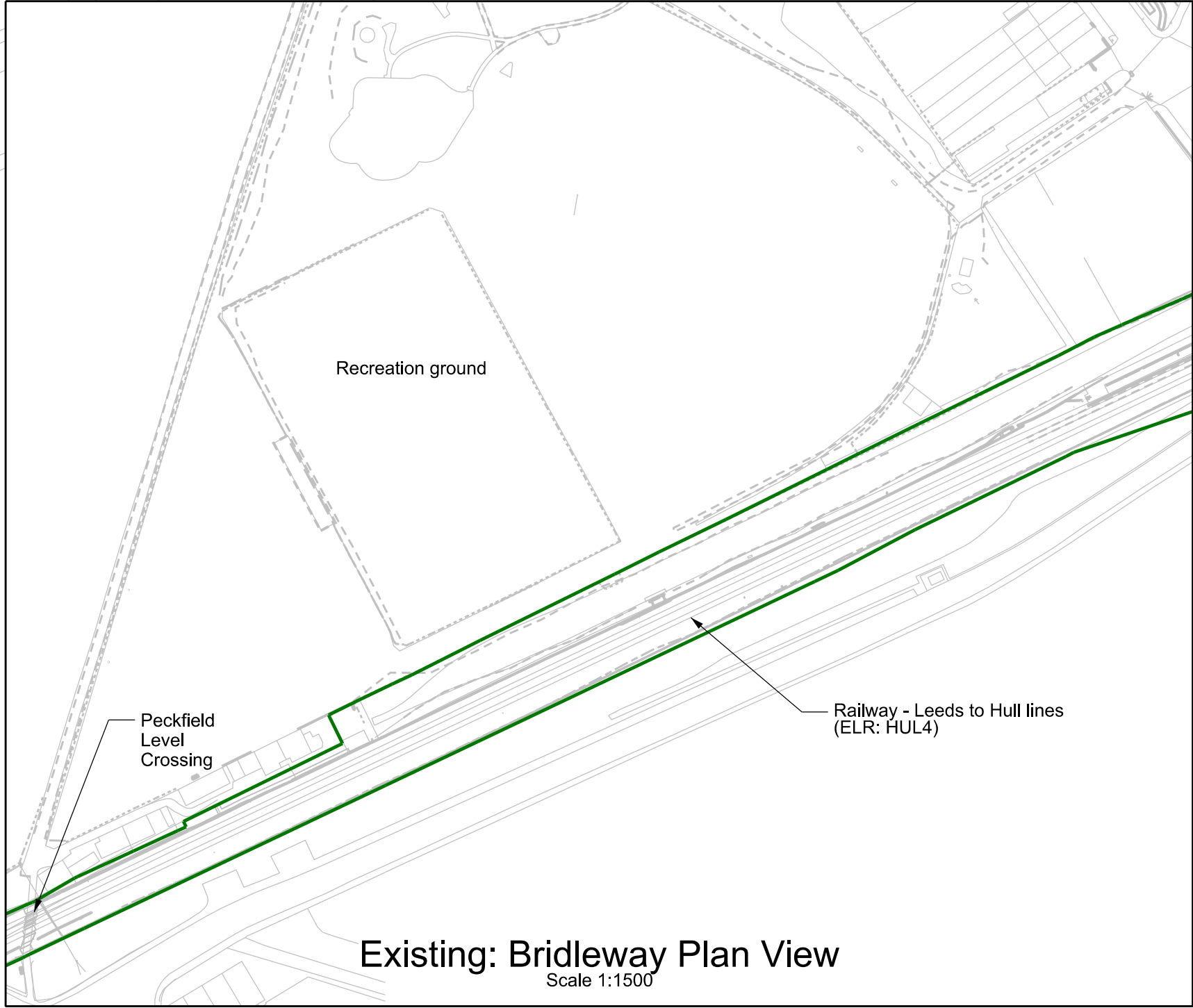

Existing: Bridleway Plan View  
Scale 1:1500

Legend/Notes

Leeds to Micklefield Enhancements Order

Notes

- All dimensions are in millimetres unless stated otherwise.
- Do not scale from this drawing.
- In constructing or maintaining the works identified as Scheduled Works in Schedule 1 of the Network Rail (Leeds to Micklefield Enhancements) Order Network Rail may deviate from the dimensions shown on this drawing to the extent permitted by the Order.
- This drawing is to be read in conjunction with:  
151666-TRA-00-HUL4-DRG-R-SG-250001 - Location Plan  
151666-TRA-00-HUL4-DRG-R-SG-250002 - Site Plan  
151666-TRA-00-HUL4-DRG-R-SG-250003 - Highway Works Detailed Plans  
151666-TRA-00-HUL4-DRG-R-SG-250004 - Footpath Detailed Plans  
151666-TRA-00-HUL4-DRG-R-SG-250005 - Footpath Proposed Sections  
151666-TRA-00-HUL4-DRG-R-SG-250006 - TSC Detailed Plans  
151666-TRA-00-HUL4-DRG-R-SG-250007 - TSC Proposed Sections  
151666-TRA-00-HUL4-DRG-R-SG-250009 - Bridleway Proposed Sections

Legend

- Proposed Infrastructure
- Existing Infrastructure
- Deemed Planning Application Boundary
- Network Rail Land Boundary

Section Call-out

000000 X-X

0 10 20 30 40 50m  
SCALE 1:500 - Proposed

0 30 60 90 120 150m  
SCALE 1:1500 - Existing

P01	29/06/23	First Issue	OM	MW	MW
Rev	Date	Description of Revisions	Drawn	Chkd	Appr
Status					Suitability
Fit for Information					S2

**NetworkRail**

Authorised		Signed	Electronically Signed	Date	
Contractor(s) <b>TRU Alliance</b>					
Location AREA BDY MICKLEFIELD TO LEEDS CITY STATION					
Type	CAD Drawing	Sub-type	Plan		
Role	Rail Engineering	Sub-Role	Signalling		
Zone					
Phasing	Proposed	Project Stage	GRIP 4		
Project <b>Transpennine Route Upgrade</b>					
Contract No. <b>151666</b>					
Contract Title <b>TRU - East of Leeds</b>					
Drawing Title <b>Peckfield Level Crossing Closure and The Lower Peckfield Lane Highway Works Detailed Plans</b>					
Designed	O.McIntosh	Signed	Electronically Signed	Date	29/06/23
Drawn	O.McIntosh	Signed	Electronically Signed	Date	29/06/23
Checked	M.Westwood	Signed	Electronically Signed	Date	29/06/23
Approved	M.Westwood	Signed	Electronically Signed	Date	29/06/23
Scale(s) <b>As Shown</b>		ELR & Mileage <b>11.0264 to 11.0264</b>			
Alternative Reference				Sheet of Revision	
Drawing Number <b>151666-TRA-00-HUL4-DRG-R-SG-250008</b>				<b>P01</b>	