

Transport and Works Act 1992
The Network Rail (Old Oak Common Great Western Mainline Track Access) Order
London Borough of Ealing

Permanent Easement
Land Plan 12
Sheet 1 of 1

Key:

 Land to be Temporarily Used and Permanent Rights of Access

Number on Plan

3

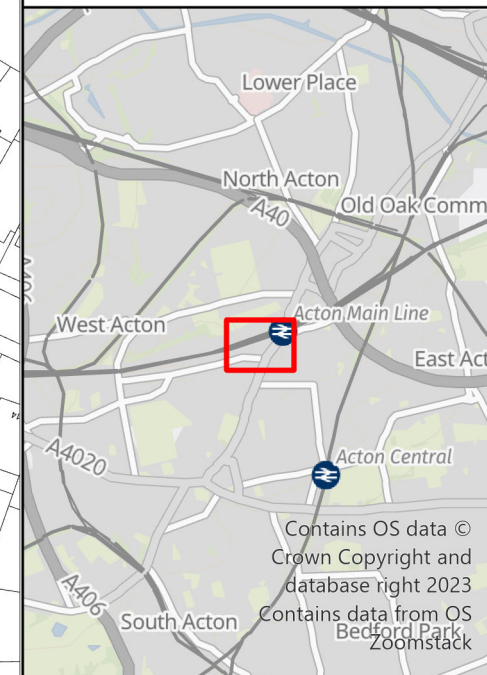
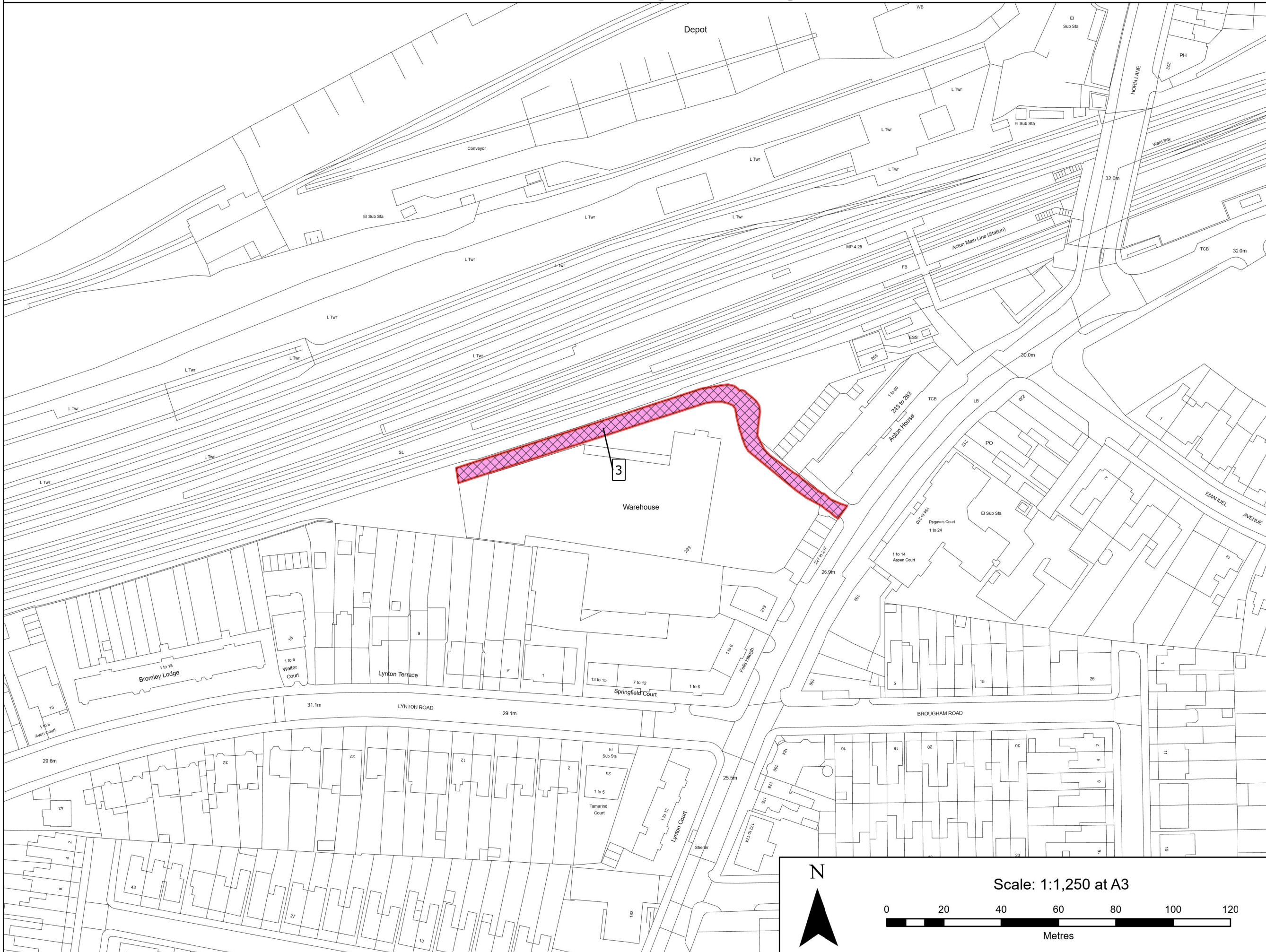

DRW No: NR QOC LP12 1250

Location: Old Oak Common, Acton
Map Centre: 520215, 181137

Version: 1.0 | Date: 12/04/2023

Where applicable the plot boundaries show the general boundary of the registered land, it does not show the exact line of the boundaries. Measurements scaled from this plan may not match measurements between the same points on the ground.

© Crown copyright 2023 OS 100022432.
You are permitted to use this data solely to enable you to respond to, or interact with, the organisation that provided you with the data. You are not permitted to copy, sub-license, distribute or sell any of this data to third parties in any form.